

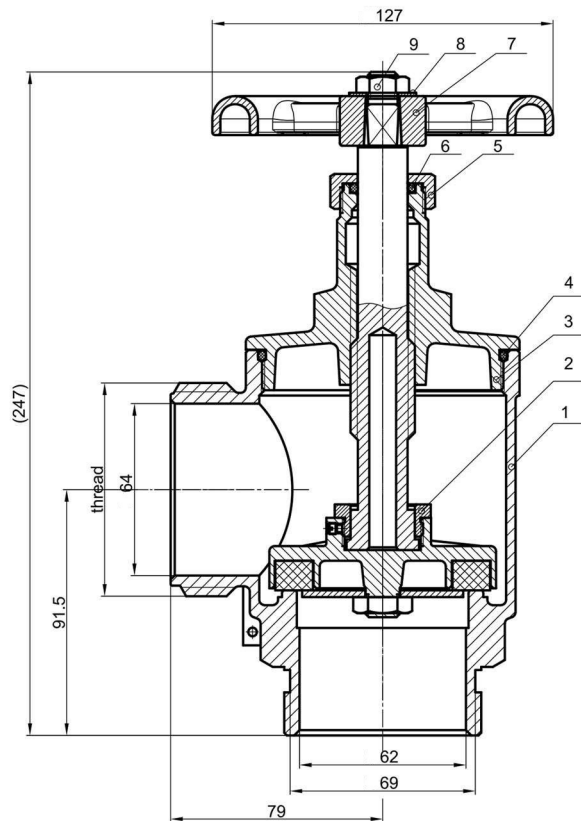

# NATIONAL FIRE EQUIPMENT LTD.

SERVICE, SOLUTIONS, INNOVATION

## NFE MODEL 25G 2 1/2" GROOVED ANGLE HOSE VALVE



Part No.	Thread	Surface Treatment	Laser
25BB-G	BCT3.000X8	Brass	BCT
25CB-G	CSA3.125X5	Brass	CSA
25QB-G	QST3.031X7	Brass	QST

### Available special order - Satin or polished chrome

5	Lock Nut	C37700			
4	O-Ring	EPDM(A70)	9	Wheel Nut	C37700
3	Bottom	C37700	8	Wheel Washer	304
2	Spool Assembly	Sub Assembly	7	Handle Wheel	ZL102
1	Body	C37700	6	O-Ring	EPDM(A70)
ITEM	DESCRIPTION	MATERIAL	ITEM	DESCRIPTION	MATERIAL

FM APPROVED & UL/ULC LISTED FOR 175 PSI
PRESSURE RATED FOR 300 PSI
HOSE VALVE 2.5"



Certificate No.: 20140110-EX16364

Approval Id: 0003049539

Etched Thread Specifications  
Laser  
Height of letter : 4mm

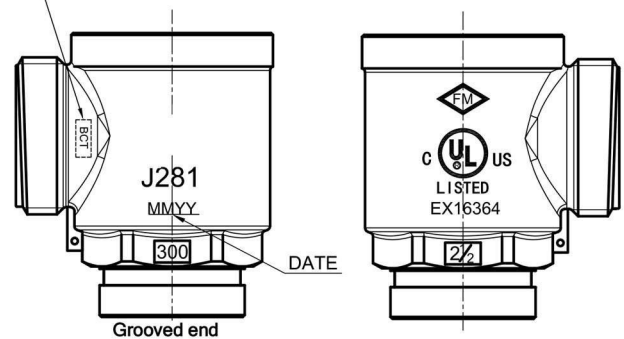

AMA and other hose threads are available. Contact customer service for more information.



# NATIONAL FIRE EQUIPMENT LTD.

SERVICE, SOLUTIONS, INNOVATION

## NFE MODEL 25 2 1/2" THREADED ANGLE HOSE VALVE

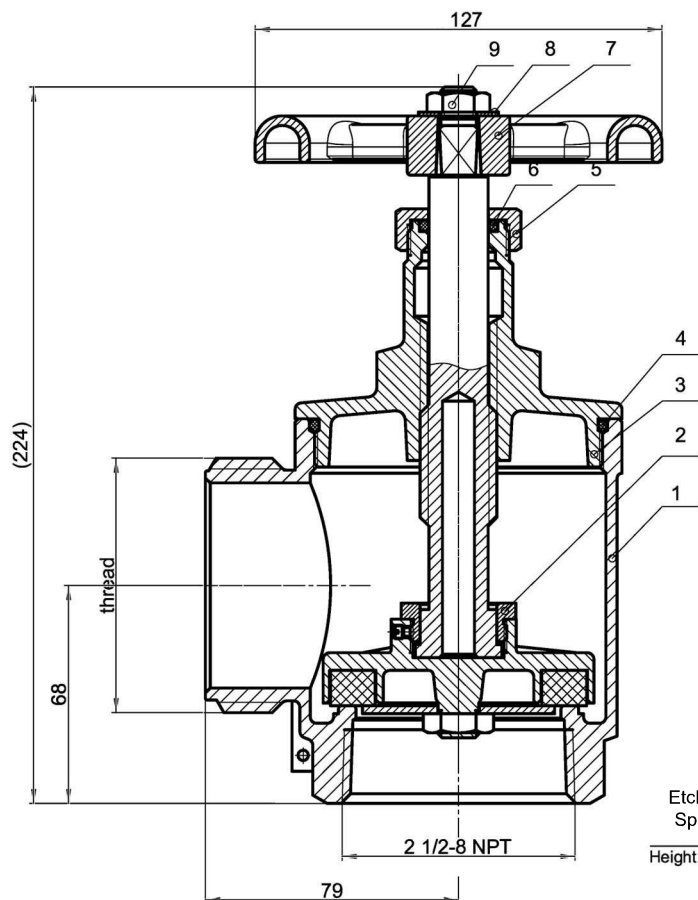

Etched Thread  
Specifications  
Laser  
Height of letter : 4mm

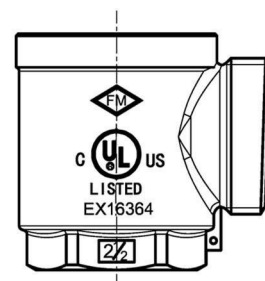
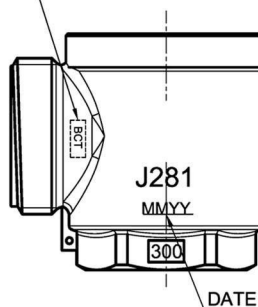

Part No.	Thread	Surface Treatment	Laser
25BB	BCT3.000X8	brass	BCT
25BC	BCT3.000X8	satin chrome plating	
25CB	CSA3.125X5	brass	CSA
25CC	CSA3.125X5	satin chrome plating	
25CPC	CSA3.125X5	polished chrome plating	MT
25MB	Moncton2.962X8	brass	
25NFB	NFLD3.250X5	brass	NFLD
25NFC	NFLD3.250X5	satin chrome plating	
25NSB	NSST3.230X5	brass	NSST
25QB	QST3.031X7	brass	
25QC	QST3.031X7	satin chrome plating	QST
25WB	WCT3.250X6	brass	
25WC	WCT3.250X6	satin chrome plating	WCT

5	Lock Nut	C37700	9	Wheel Nut	C37700
4	O-Ring	EPDM(A70)	8	Wheel Washer	304
3	Bottom	C37700	7	Handle Wheel	ZL102
2	Spool Assembly	Sub Assembly	6	O-Ring	EPDM(A70)
1	Body	C37700			
ITEM	DESCRIPTION	MATERIAL	ITEM	DESCRIPTION	MATERIAL

FM APPROVED & UL/ULC LISTED FOR 175 PSI
PRESSURE RATED FOR 300 PSI
HOSE VALVE 2.5"



Certificate No: 20140110-EX16364

Approval Id: 0003049539

AMA and other hose threads are available. Contact customer service for more information.



**TORONTO HEAD OFFICE**  
(905) 761-6355  
Toll Free: (800) 267-8508

**VANCOUVER** (604) 420-1131  
Toll Free: (800) 667-2138

**OTTAWA** (613) 723-6071

www.nationalfire.com

**EDMONTON** (780) 455-3870  
Toll Free: (888) 891-1008

**CALGARY** (403) 236-5661

**MONCTON** (506) 859-7277  
Toll Free: (877) 816-3473

**MISSISSAUGA** (905) 565-1385