

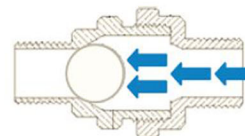

National Fire Equipment Ltd.

Automatic Horizontal Ball Drip NFE-A58 Series

A58

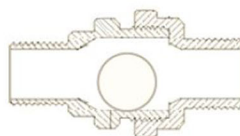
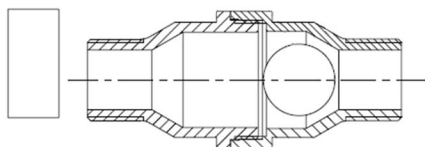

Pressure from
FDC

Description

The ball drip is installed at the low point in the fire department connection piping of automatic sprinkler systems.

Under fire conditions, water pressure from a fire department pumper pumping into the FDC (Fire Department Connections) automatically closes this valve. When the pressure ceases, the ball drip automatically re-opens, permitting this piping to drain and thereby preventing freezing. The A58 must be installed in horizontal position only.

The internal ball rests in the lowest area of the valve body allowing for proper drainage of water accumulation. Upon FDC pressurization, the internal ball is "pushed" into the small end of the ball drip body closing the opening.

When pressure is removed, gravity returns the ball to its original position.

Series	Size	Type	Finishing
A58	1/2"	NPT (M)	Rough Brass
	3/4"	X NPT (M)	

Technical data

- Rated pressure: 300 PSI (20,6 bar)

Materials

- Body: Forged brass
- Ball: Stainless steel

Product Specifications - A58

Automatic horizontal ball drip, for the installation in the low point in the Fire Department connection piping of automatic sprinkler systems, permitting, when not pressurized, this piping to drain and thereby preventing freezing and automatically sealing under pressure..With main feature as following:

- Forged brass body
- Stainless steel ball
- 1/2", 3/4" NPT (M x M)
- Rated pressure 300 psi

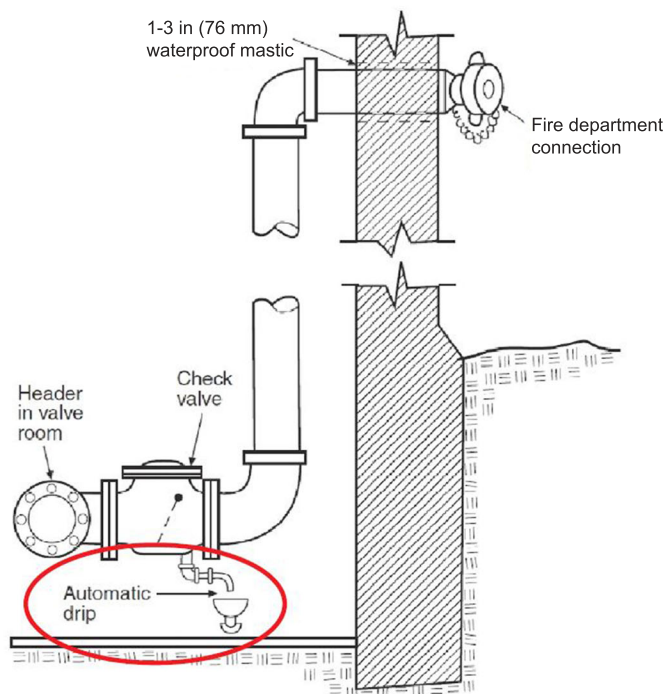

Dimensions

A58 - HORIZONTAL BALL DRIP

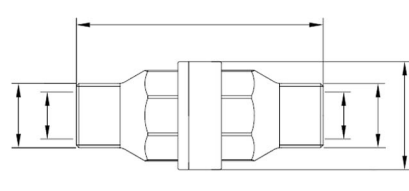
	
Size	A
1/2"	2 11/16"
3/4"	2 11/16"



National Fire
Equipment Ltd.

TORONTO: (905) 761-6355

Toll Free: (800) 267-8508

OTTAWA: (613) 723-6071

VANCOUVER: (604) 420-1131

Toll Free: (800)-667-2138

BURNABY: (604)-299-4498

EDMONTON: (780) 455-3870

Toll Free: (888)-891-1008

CALGARY: (403) 236-5661

MONCTON: (506) 859-7277

Toll Free: (877) 816-3473

MISSISSAUGA: (905) 565-1385

www.nationalfire.com