



NATIONAL FIRE EQUIPMENT LTD.
SERVICE, SOLUTIONS, INNOVATION

PIPE SADDLE SUPPORT NFE



Pipe Saddle Support with U-Bolt

- Cast iron stanchion saddle with steel yoke and nuts.
- Stanchion type support with additional stability provided by U-bolt attachment to pipe.
- Available in 4", 6" and 8" c/w 2" female NPT outlet.
- Part #: PSS4020 (4"), PSS6020 (6") & PSS8020 (8").

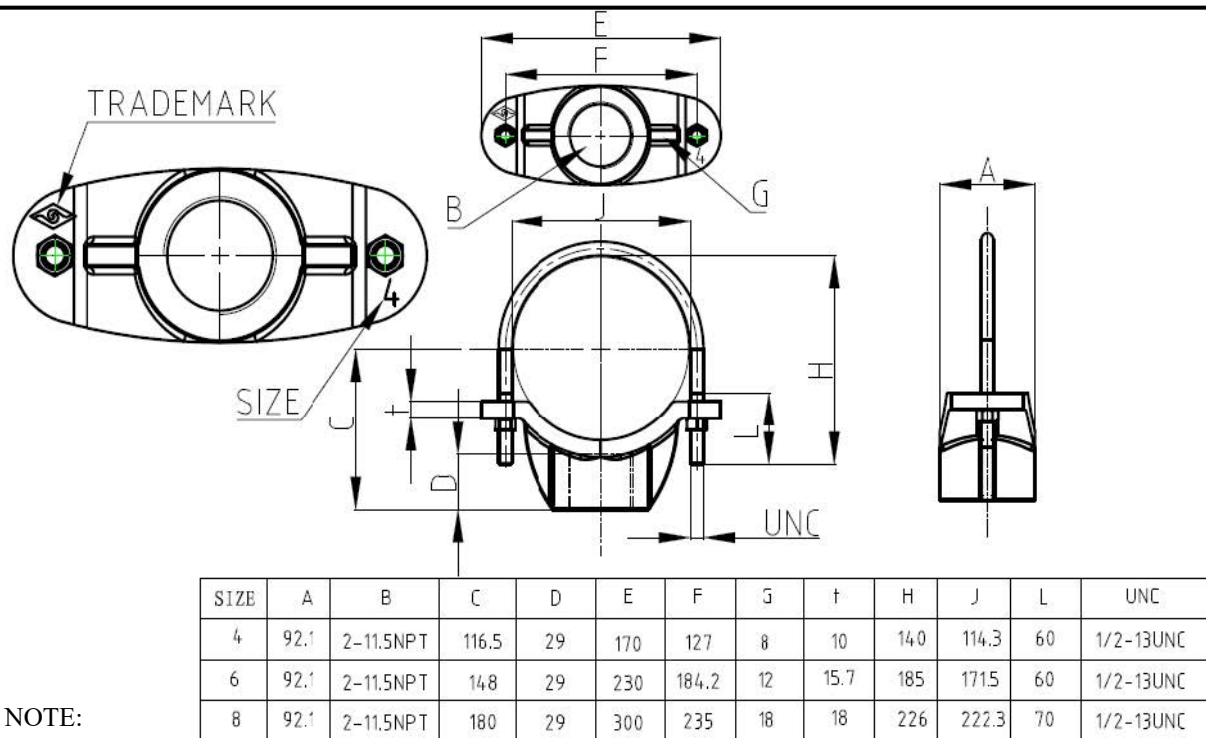

NOTE:

1. Surface of the castings should be smooth, without any hole spores and visual defectives.
2. Thread according to ASME B1. 20, 1;
3. Casting tolerances according to ISO 8062 CT9

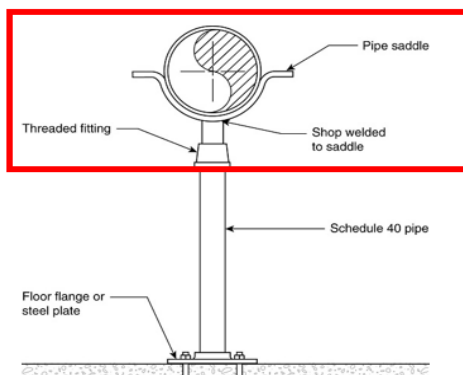

NFPA 13, Section 17.5 header pipe stands. These stands meet the requirements of NFPA 13, they must however be installed as per section 17.5.