

# Series 909, LF909

## Reduced Pressure Zone Assemblies

Sizes 3/4" – 2"

### Check valve kits

When ordering specify Ordering Code, Kit No., and Valve Size.

Note: 1 1/4" – 2" 909/909M1 are common kits.

ORDERING CODE	KIT NO.	SIZE
---------------	---------	------

#### First Check Kits

LEAD FREE	ORDERING CODE	KIT NO.	SIZE
	0887120	RK 909 CK1	3/4" – 1"
	0794063	LFRK 909M1 CK1	1 1/4" – 2"
	0794063	LFRK 909M1 CK1	1 1/4" – 2"
	0887122	RK 909 CK1SS**	3/4" – 1"
	0887135	RK 909M1 CK1SS**	1 1/4" – 2"

#### Second Check Kits

LEAD FREE	ORDERING CODE	KIT NO.	SIZE
	0887121	RK 909 CK2	3/4" – 1"
	0794064	LFRK 909M1 CK2	1 1/4" – 2"
	0794064	LFRK 909M1 CK2	1 1/4" – 2"
	0887123	RK 909 CK2SS**	3/4" – 1"
	0887136	RK 909M1 CK2SS**	1 1/4" – 2"

Kit consists of: disc assembly, spring, seat, seat O-ring and lubricant.

#### Rubber Parts for Both Checks

LEAD FREE	ORDERING CODE	KIT NO.	SIZE
	0887129	RK 909 RC3	3/4" – 1"
	0887310	RK 909 RC3 HW	3/4" – 1"
	0794065	LFRK 909M1 RC3	1 1/4" – 2"
	0794068	LFRK 909M1 RC3 HW	1 1/4" – 2"

Kit consists of: disc assembly, seat O-ring, cover O-ring and lubricant.

NOTE: HW model has bronze disc assembly.

#### Complete Rubber Parts

LEAD FREE	ORDERING CODE	KIT NO.	SIZE
	0794069	LFRK 909 RT	3/4" – 1"
	0794070	LFRK 909M1 RT	1 1/4" – 2"

Kit consists of: disc assembly, seat O-rings, RV diaphragm, RV O-rings, piston O-rings, cover O-rings and lubricant.

#### Seat Kits for One Check

LEAD FREE	ORDERING CODE	KIT NO.	SIZE
	0887124	RK 909 S	3/4" – 1"
	0887139	RK 909M1 S	1 1/4" – 2"
	0887125	RK 909 S-SS**	3/4" – 1"
	0887140	RK 909M1 S-SS**	1 1/4" – 2"

Kit consists of: seat, seat O-ring and lubricant.

#### Cover Kits

LEAD FREE	ORDERING CODE	KIT NO.	SIZE
	0794072	LFRK 909 C1	3/4" – 1"
	0794073	LFRK 909 C2	3/4" – 1"
	0794074	LFRK 909M1-C4	1 1/4" – 2"
	0794075	LFRK 909-VC	3/4" – 1"
	0794076	LFRK 909M1-VC	1 1/4" – 2"

Kit consists of: cover, cover O-ring and lubricant.

 National Fire Equipment Ltd.  
Your Backflow Parts Depot!

 **WATTS**<sup>®</sup>  
Watts Water Technologies, Inc.

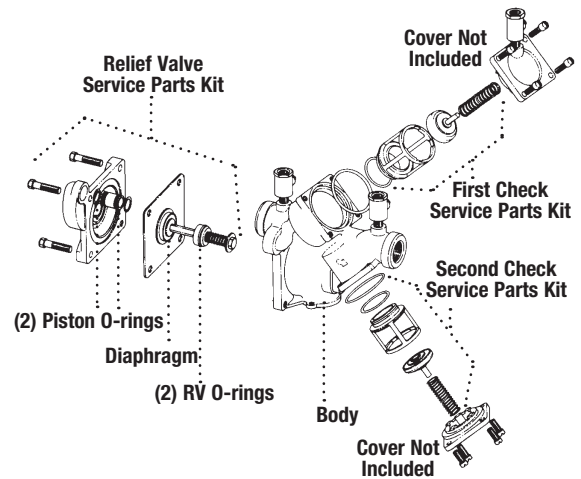
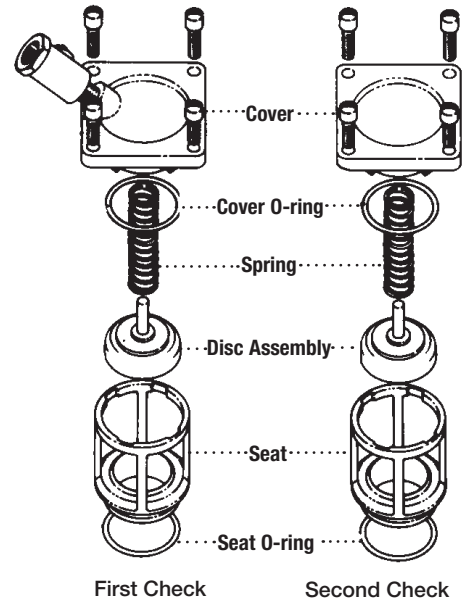

NOTE: No special tools required to service Series 909.

NOTE: Rubber seat disc can be replaced. However, disc holder and disc retainer are permanently bonded to prevent failure.

ORDERING CODE	KIT NO.	SIZE	LIST PRICE
---------------	---------	------	------------

#### Polymer Coated Valves

LEAD FREE	ORDERING CODE	KIT NO.	SIZE	LIST PRICE
	0794079	LFRK 909-PC-CK1	3/4"-1"	\$176.24
	0794080	LFRK 909-PC-CK2	3/4"-1"	216.50
	0794077	909M1-PC-CK1	1 1/4"-2"	248.02
	0794078	909M1-PC-CK2	1 1/4"-2"	406.60

Kit consists of: disc assembly, seat, seat O-ring, sleeve, check spring, PC cover and cover O-ring.

\*The wetted surface of this product contacted by consumable water contains less than 0.25% of lead by weight.

\*\*Stainless steel seat

# Series 909, LF909



## Reduced Pressure Zone Assemblies

Sizes  $\frac{3}{4}$ " - 2"

### Repair Kits

When ordering specify Ordering Code, Kit No., and Valve Size.

ORDERING CODE	KIT NO.	SIZE
<b>Total Repair Kits</b>		
0794066	LFRK 909-T	$\frac{3}{4}$ "-1"
0794071	LFRK 909M1-T	1 $\frac{1}{4}$ "-2"

Kit consists of: relief valve repair kit, first check repair kit, second check repair kit

### Relief Valve Kits

RELIEF VALVE KIT	RELIEF VALVE KIT NO.	SIZE
<b>Relief Valve Kits</b>		
0794059	LFRK 909 VT	$\frac{3}{4}$ " - 1"
0794060	LFRK 909M1 VT	1 $\frac{1}{4}$ " - 2"

Kit consists of: relief valve assembly, seat, seat O-ring, 2 piston O-rings and lubricant.

### Rubber Parts for Relief Valve

0794061	LFRK 909 RV	$\frac{3}{4}$ " - 1"
0794062	LFRK 909M1 RV	1 $\frac{1}{4}$ " - 2"

Kit consists of: diaphragm, disc assembly, seat O-ring, RV O-ring, 2 piston O-ring, and lubricant.

### Seat Kits for Relief Valve

0887372	RK 909 SV	$\frac{3}{4}$ " - 1"
0887371	RK 909M1 SV	1 $\frac{1}{4}$ " - 2"

Kit consists of: seat, seat O-ring, 2 piston O-ring and lubricant.

$\frac{3}{4}$ " - 1"

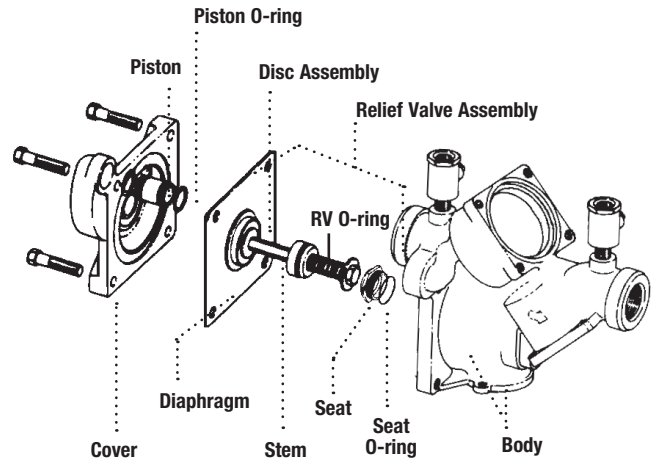

1  $\frac{1}{4}$ " - 2"

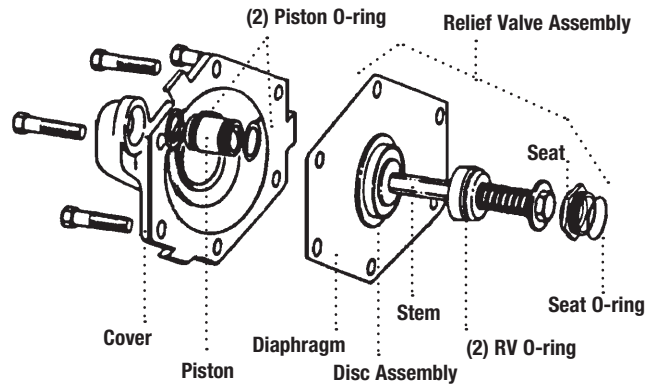

**NOTE:** 1  $\frac{1}{4}$ " - 2" 909/909M1 are common kits.

**TO PREVENT SHAFT DAMAGE ASSEMBLE AS SHOWN:** If cover will not press against body, assembly is crooked and tightening bolts will bend shaft. Do not force the cover into place as damage may result from misalignment.

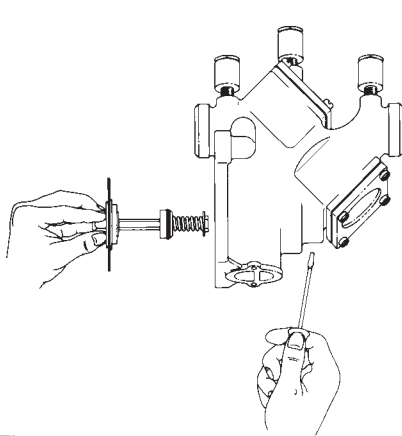

**Figure 1:**  
To assemble the relief valve assembly have a screwdriver ready.

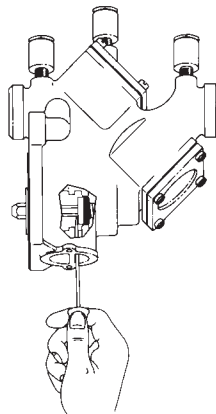

**Figure 2:**  
Depress the relief valve assembly, carefully guiding it against the two pound spring load. When properly aligned, the piston is in the cylinder bore. Insert the screwdriver as shown.

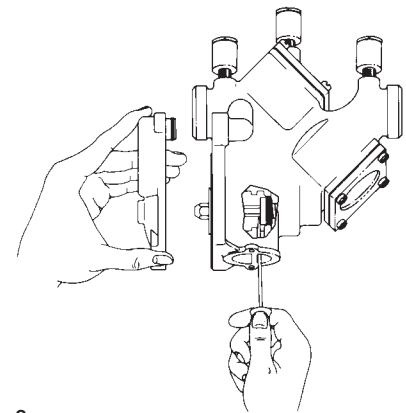

**Figure 3:**  
The relief valve assembly is held encapsulated by the screwdriver. You should now have both hands free to bolt down the cover. Insert and snug two bolts 180° apart to hold the cover. Finish inserting the remaining bolts and snug up evenly alternating until secure. Remove the screwdriver.

\*The wetted surface of this product contacted by consumable water contains less than 0.25% of lead by weight.