



National Fire Equipment Ltd.

Model CKVASG "SHOTGUN" Swing Check Valve - GXG

Description

Style CKVASG is a Swing Check Valve. A vertical installed non-return valve in a "Shotgun" arrangement. With trim unit, the check valve utilizes an electric flow switch and alarm bell instead of a water motor gong for fire notification. Valve body is the same as style CKVAG, easy to adapt on job field.

Product features

- Rated working pressure 365psi/25bars by UL/cUL listing and FM approval;
- One design with regular swing check valve style CKVAG;
- Drains can be optionally provided both upstream and downstream of the clapper;
- Innovative hydro-dynamically efficient profile lowers pressure drop;
- Sealing achieved by a low head pressure of 0.15bar/2psi;
- All wetted parts made by anti-corrosion material to provide superior service time;
- Grooved end conforming to AWWA C606 for easy installation and maintenance.

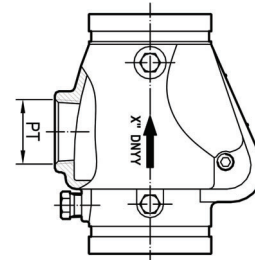

Thread size table at PT

Product No.	Nominal Size		OD	PT standard thread size
	In	DN		
CKVASG200	2	50	60.3	1"
CKVASG250	2 1/2	65	73.0	1-1/4"
CKVASG300	3	80	88.9	1-1/4"
CKVASG400	4	100	114.3	2"
CKVASG600	6	150	168.3	2"
CKVASG800	8	200	219.1	2"

CKVASG SHOTGUN with trim arrangement

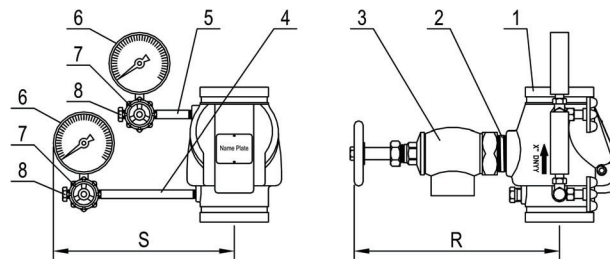

Nominal Size	Pipe O.D.	S	R	1	2	3	4	5	6	7	8
DN	mm	mm	mm	CKVASG	Close Nipple	Angle Valve	1/4" Nipple	1/4" Nipple	Water Gauge	3 Way Valve	Plug
In.	In.	In.	In.								
50	60.3	222	254	60	1"	1"	140mm 5-1/2"	38mm 1-1/2"	1/4"	1/4"	1/4"
2	2.375	8.75	10								
65	73.0	235	280	73	1-1/4"	1-1/4"	140mm 5-1/2"	51mm 2"	1/4"	1/4"	1/4"
2 1/2	2.875	9.25	11								
80	88.9	241	305	89	1-1/4"	1-1/4"	140mm 5-1/2"	51mm 2"	1/4"	1/4"	1/4"
3	3.500	9.5	12								
100	114.3	254	343	114	2"	2"	140mm 5-1/2"	64mm 2-1/2"	1/4"	1/4"	1/4"
4	4.500	10	13.5								
150	168.3	280	375	168	2"	2"	140mm 5-1/2"	64mm 2-1/2"	1/4"	1/4"	1/4"
6	6.625	11	14.75								
200	219.1	305	400	219	2"	2"	140mm 5-1/2"	64mm 2-1/2"	1/4"	1/4"	1/4"
8	8.625	12	15.75								

Note: Shotgun trim extra

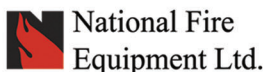

TORONTO: (905) 761-6355
Toll Free: (800) 267-8508
OTTAWA: (613) 723-6071

VANCOUVER: (604) 420-1131
Toll Free: (800)-667-2138
BURNABY: (604)-299-4498

EDMONTON: (780) 455-3870
Toll Free: (888)-891-1008
CALGARY: (403) 236-5661

MONCTON: (506) 859-7277
Toll Free: (877) 816-3473
MISSISSAUGA: (905) 565-1385

www.nationalfire.com