

*innova*TUBE

Ever Ready Fire Extinguisher Stand

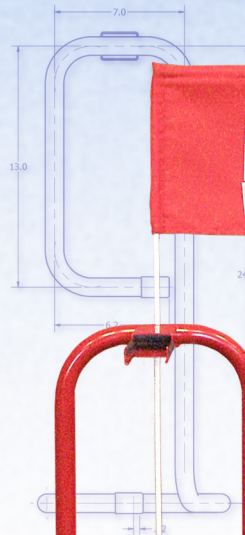
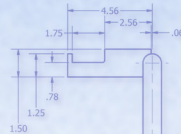
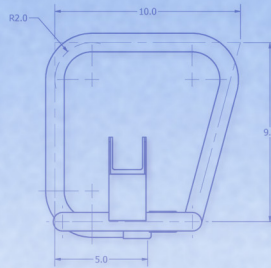

Ever Ready

Fire Extinguisher Stand

Modern style and improved visibility in standard red or a custom color that will fit your decor.

Portability ensures your extinguisher is always in an ideal location. Move the stand to where it's needed in rapidly changing environments like construction sites or rooms with varied layouts and uses.

Perfect where mounting is difficult or will blemish wall surfaces such as exhibition halls, office buildings, public buildings and hotels.

Avoid the damage common to wall mounted extinguishers caused by passing traffic.

The stand's visibility immediately highlights a missing extinguisher, preventing theft.

Add flair to your fire protection with this strong, single-piece stand. The universal bracket fits all sizes and types of extinguisher.

Technical Specifications

- *lightweight single piece tubular frame with UV protected powder coat paint*
- *universal bracket for any type of extinguisher*
- *27" high, 13" wide and 14" deep*

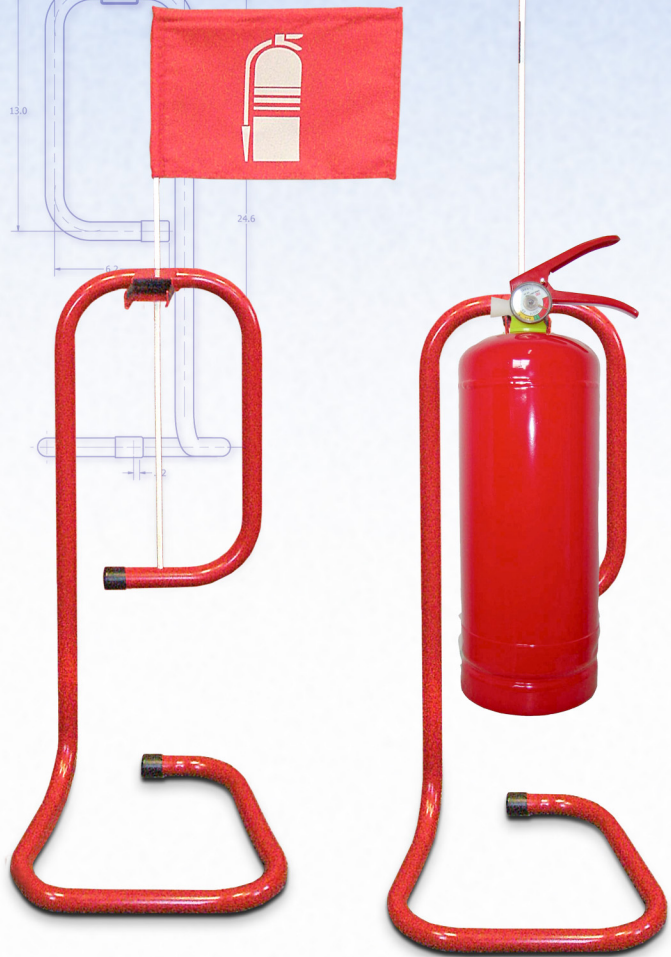

National Fire Equipment Ltd.

Head Office: (905) 761-6355
www.nationalfire.com

*innova*TUBE

innovation in tube