

April 2012

For the most current product/pricing information on Anvil products, please visit our website at www.anvilintl.com.



Fire Products

BUILDING CONNECTIONS THAT LAST



SPF™ Grooved Couplings & Flanges

SPF™ Grooved Product Line

SPF Grooved products are internationally manufactured to meet the most stringent standards as well as being UL/ULC listed and FM approved.



SPF™ Model C-4 Rigid Coupling

The SPF Model C-4 Rigid Coupling is specially designed to provide a rigid, locked-in pipe connection to meet the specific demands of a rigid piping system not allowing for expansion, contraction or deflection. Fast and easy swing-over installation of the rugged lightweight housing produces a secure, rigid pipe joint. The Model C-4 Rigid Coupling is UL/ULC Listed and FM Approved for fire protection service in both wet and dry systems, with roll grooved or cut grooved steel pipe prepared in accordance with Gruvlok grooving specifications. For the latest UL/ULC listed and FM approved pressure ratings versus pipe schedule, see www.anvilintl.com or contact your local Anvil Representative.

The Model C-4 Rigid Coupling with a Pre-Lubricated Grade "E" EPDM, Type "A" gasket is intended for use in fire protection systems installed in accordance with NFPA Standard 13 "Sprinkler Systems".

Available 1 1/4" – 8" nominal pipe sizes.

SPF™ Model C-3 Lightweight Flexible Coupling

The SPF Model C-3 Lightweight Flexible Coupling is designed for applications where system flexibility is desired. The Model C-3 Lightweight Flexible Coupling is approximately 30% lighter in weight than the Figure 7001 Coupling. For the latest UL/ULC listed and FM approved pressure ratings versus pipe schedule, see www.anvilintl.com or contact your local Anvil Representative.

The Model C-3 Lightweight Flexible Coupling with a Pre-Lubricated Grade "E" EPDM, Type "A" gasket is intended for use in fire protection systems installed in accordance with NFPA Standard 13 "Sprinkler Systems".

Available 1 1/4" – 8" nominal pipe sizes.



SPF™ Model RC-2 Reducing Coupling

The SPF Model RC-2 Reducing Coupling makes it possible to directly connect two different pipe sizes, eliminating the need for two couplings and a reducing fitting. The specially designed reducing coupling gasket with a center rib assures proper positioning of the gasket and prevents the smaller pipe from telescoping into the larger during assembly. For the latest UL/ULC listed and FM approved pressure ratings versus pipe schedule, see www.anvilintl.com or contact your local Anvil Representative. Model RC-2 Reducing Coupling comes complete with Grade "E" EPDM Gasket.

Available 2" – 8" nominal pipe sizes.

SPF™ Model F-3 Flange

The SPF Model F-3 Flange allows direct connection of Class 125 or Class 150 flanged components to a grooved piping system. The two interlocking halves of the 2" thru 12" sizes of the SPF Flange are hinged for ease of handling, and are drawn together by a latch bolt which eases assembly on the pipe. Precision machined bolt holes, key and mating surfaces assure concentricity and flatness to provide exact fit-up with flanged, lug, and wafer styles of pipe system equipment. A specially designed gasket provides a leak-tight seal on both the pipe and the mating flange face. For the latest UL/ULC listed and FM approved pressure ratings versus pipe schedule, see www.anvilintl.com or contact your local Anvil Representative.

SPF Flanges have designed-in anti-rotation tines which bite into and grip the sides of the pipe groove to provide a secure, rigid connection. The SPF Model F-3 Flange requires the use of a steel adapter insert when used against rubber faced surfaces, wafer/lug design valves and serrated or irregular sealing surfaces. Flange comes complete with Grade "E" EPDM Gasket.

Available 2" – 12" nominal pipe sizes.





SPF™ Grooved Fittings



SPF™ Fittings for Grooved End Pipe

SPF Grooved Couplings and Fittings provide a rigid or flexible pipe connection for fire protection systems with dependable seals over a range of internal pressure situations. SPF also offers Short Pattern Products through 8" to meet all of your fire protection needs.

Material Specifications:

- ◆ **Cast Fittings:**
Ductile iron conforming to ASTM A 536
- ◆ **Fabricated Fittings:**
1-10" Carbon steel, Schedule 40, conforming to ASTM A 53, Grade B
12" Carbon steel, Standard Wall, conforming to ASTM A 53, Grade B
- ◆ **Coating:**
Rust inhibiting paint Color: ORANGE (standard)
Hot-dipped zinc galvanized conforming to ASTM A 153 (optional)

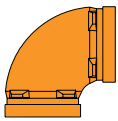

SPF Style SE-1
90° Elbow (Short Body)

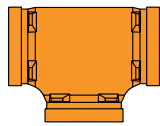

SPF Style ST-1
Standard Tee (Short Body)

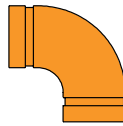

SPF Style E-1
90° Elbow

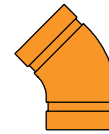

SPF Style E-2
45° Elbow



SPF Style E-3
22 1/2° Elbow



SPF Style E-4
11 1/4° Elbow

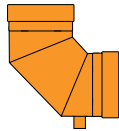

SPF Style E-9
90° Drain Elbow

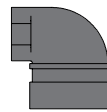

SPF Style SE-5
Reducing 90° Elbow
(Groove x Thread)



SPF Style SK-1
Cap



SPF Style K-9
Drain Cap

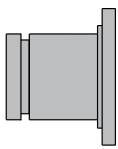

SPF Style F-2
Flange Nipple (ANSI 150)

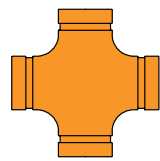

SPF Style X-1
Steel Cross

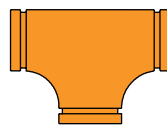

SPF Style T-1
Straight Tee

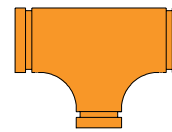

SPF Style T-2
Reducing Tee

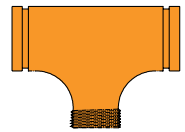

SPF Style T-3
Reducing Tee with
Threaded Branch



SPF Style R-2
Eccentric Reducer

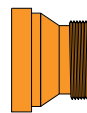

SPF Style R-3
Concentric Reducer (Groove x Thread)

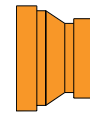

SPF Style R-1
Concentric Reducer

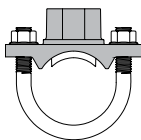

SPF Style MT-30
Mechanical Branch Tee (Threaded)

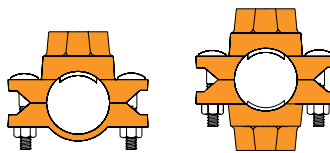

SPF Style MT-1
Mechanical Branch Tee (Threaded)

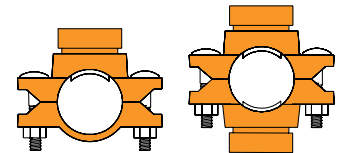

SPF Style MT-2
Mechanical Branch Tee (Grooved)

