



# National Fire Equipment Ltd.

## FIG. MT-30 Threaded Mechanical Branch Tee

The MT-30 mechanical tee serves the same function as the MT-1 and MT-8, but uses a steel electro-plated u-bolt to save space and for easier installation in tight places. The MT-30 is ideal for direct connections with sprinkler heads and drop nipples. The MT-90 is the BSPT equivalent.

For the latest UL/ULC listed, LPCB, VdS and FM Approved pressure ratings versus pipe schedule, see [www.anvilintl.com](http://www.anvilintl.com) or contact your local Anvil Representative.

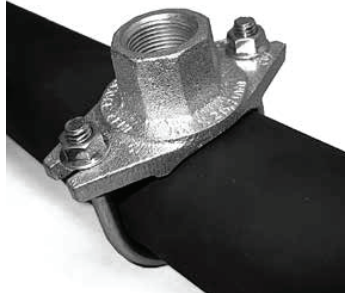

For Listings/Approval Details and Limitations, visit our website at [www.anvilintl.com](http://www.anvilintl.com) or contact an Anvil® Sales Representative.

### MATERIAL SPECIFICATIONS

#### HOUSING:

Ductile Iron conforming to ASTM A-536, Grade 65-45-12

#### U-BOLTS & NUTS:

U-bolt is carbon steel SAE J429 Gr. 2, zinc plated complete with hex flanged lock nuts conforming to ASTM A-563 Gr. A or B of SAE J995 Gr. 2.

#### THREADS:

NPT per ANSI/ASME B1.20.1.

#### Coatings:

- Zinc Electroplated
- Other available options: Example: RAL3000 or RAL9000 Series

#### GASKETS: Materials

Properties as designated in accordance with ASTM D-2000.

- **Grade "E" EPDM** (Green color code)
  - 40°F to 230°F (Service Temperature Range) (-40°C to 110°C)
- Recommended for water service, diluted acids, alkalies solutions, oil-free air and many chemical services not involving hydrocarbons, oils or gases.
- NOT FOR USE WITH HYDROCARBONS.**



National Fire  
Equipment Ltd.

TORONTO: (905) 761-6355  
Toll Free: (800) 267-8508

OTTAWA: (613) 723-6071

VANCOUVER: (604) 420-1131  
Toll Free: (800)-667-2138

BURNABY: (604)-299-4498

EDMONTON: (780) 455-3870  
Toll Free: (888)-891-1008

CALGARY: (403) 236-5661

MONCTON: (506) 859-7277  
Toll Free: (877) 816-3473

MISSISSAUGA: (905) 565-1385

[www.nationalfire.com](http://www.nationalfire.com)



# National Fire Equipment Ltd.

**FIG. MT-30 Threaded Mechanical Branch Tee**

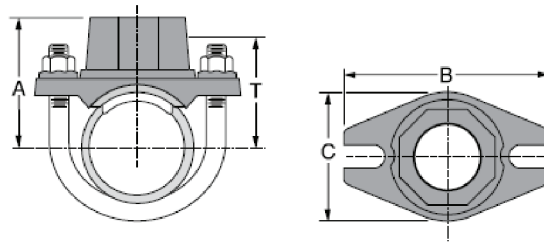

## MT-30 THREADED MECHANICAL BRANCH TEE

Nominal Size	O.D.	Hole Dimensions		Max. Working Pressures	Dimensions				Approx. Wt. Ea.
		Min. Diameter	Max. Diameter		A	B	C	T Take-out	
In./DN(mm)	In./mm	In./mm	In./mm	PSI/bar	In./mm	In./mm	In./mm	In./mm	Lbs./Kg
1 1/4 x 1/2 32 x 12	1.660 x 0.840 42.4 x 21.3	1 3/16 30	1 5/16 33	300 20.7	2 1/8 54	3 1/2 89	2 1/4 57.2	1 5/8 42	0.8 0.4
1 1/4 x 3/4 32 x 19	1.660 x 1.050 42.4 x 26.7	1 3/16 30	1 5/16 33	300 20.7	2 1/8 54	3 1/2 89	2 1/4 57.2	1 5/8 42	0.8 0.4
1 1/4 x 1 32 x 25	1.660 x 1.315 42.4 x 33.7	1 3/16 30	1 5/16 33	300 20.7	2 1/4 58	3 1/2 89	2 1/4 57.2	1 5/8 41	1.1 0.5
1/2 x 1/2 40 x 12	1.900 x 0.840 48.0 x 21.3	1 3/16 30	1 5/16 33	300 20.7	2 1/4 57	3 1/2 89	2 1/4 57.2	1 3/4 48	0.8 0.4
1 1/2 x 3/4 40 x 19	1.900 x 1.050 48.0 x 26.7	1 3/16 30	1 5/16 33	300 20.7	2 1/4 57	3 1/2 89	2 1/4 57.2	1 3/4 48	0.9 0.4
1 1/2 x 1 40 x 25	1.900 x 1.315 48.0 x 33.7	1 3/16 30	1 5/16 33	300 20.7	2 3/8 61	3 1/2 89	2 1/4 57.2	1 3/4 48	1.1 0.5
2 x 1/2 50 x 12	2.375 x 0.840 60.3 x 21.3	1 3/16 30	1 5/16 33	300 20.7	2 1/2 64	3 3/4 95	2 1/4 57.2	2 51	0.9 0.4
2 x 3/4 50 x 19	2.375 x 1.050 60.3 x 26.7	1 3/16 30	1 5/16 33	300 20.7	2 1/2 64	3 3/4 95	2 1/4 57.2	2 51	0.9 0.4
2 x 1 50 x 25	2.375 x 1.315 60.3 x 33.7	1 3/16 30	1 5/16 33	300 20.7	2 5/8 67	3 3/4 95	2 1/4 57.2	2 50	1.1 0.5
2 1/2 x 1/2 65 x 12	2.875 x 0.840 73.0 x 21.3	1 3/16 30	1 5/16 33	300 20.7	2 3/4 70	4 1/4 108	2 1/4 57.2	2 1/4 57	0.9 0.4
2 1/2 x 3/4 65 x 19	2.875 x 1.050 73.0 x 26.7	1 3/16 30	1 5/16 33	300 20.7	2 3/4 70	4 1/4 108	2 1/4 57.2	2 1/4 57	0.9 0.4
2 1/2 x 1 65 x 25	2.875 x 1.315 73.0 x 33.7	1 3/16 30	1 5/16 33	300 20.7	2 7/8 73	4 1/4 108	2 1/4 57.2	2 1/4 56	1.1 0.5

BSP equivalent is available as a MT-90.

– Working Pressure Ratings are for reference only and based on Sch. 10 and Sch. 40 pipe. For the latest UL/ULC, FM, VdS and LPCB pressure ratings versus pipe schedule, please visit [anvilintl.com](http://anvilintl.com) or contact your local Anvil Representative.

**Note:** Tighten nuts alternately to a recommended torque of 18-22 ft.-lbs. (25-30 Nm) on pipe wall less than schedule 10 (Din 2440) or 23-27 ft.-lbs. (31-37 Nm) on pipe walls schedule 10 (DIN 2440) and above.

**WARNING**

For dry pipe systems and freezer applications lubrication of the gasket is required, Gruvlok® Xtreme™ Lubricant is required.



# National Fire Equipment Ltd.

## FIG. MT-30 & MT-90 Threaded Mechanical Branch Tees

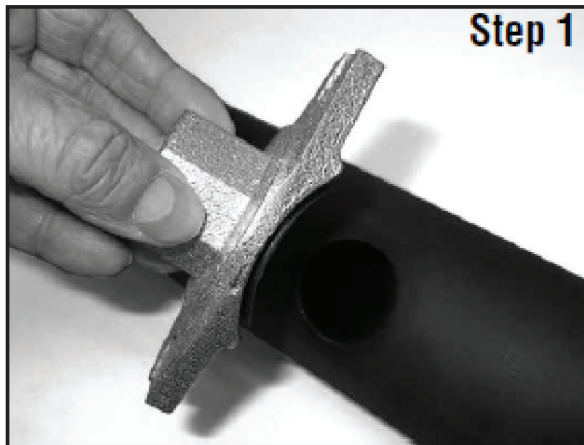

### 1 Alignment

Align the gasket and fitting above the 1.19" (30mm) pipe hole.



### 2 Housing Assembly

Attach the U-bolt from the other side and fasten the nuts finger tight.

Branch Size	Hole Saw Size	EQUIVALENT PIPE LENGTH
Inches (mm.)	Inches +1/8, -0 (mm +3, -0)	(see note)
1 25	1.19 30.23	5 1.52

Note: Flow Data is expressed as Feet/Meters of Schedule 40 steel outlet pipe with a "Hazen-Williams coefficient of friction value of 120".



### 3 Tighten Nuts

Making sure the fitting is properly located over the pipe hole, use a 9/16" (14 mm) wrench to tighten the nuts alternatively to a recommended torque of 18-22 ft.-lbs. (25-30 Nm) on pipe wall less than schedule 10 (DIN 2440) or 23-27 ft.-lbs. (31-37 Nm) on pipe walls schedule 10 (DIN 2440) and above.

### Specified Bolt Torque

Specified bolt torque is for the u-bolt used on SPF® threaded mechanical branches. The nuts must be tightened alternately and evenly until fully tightened.

**Caution:** Proper torquing of mechanical branch u-bolt is required to obtain specified performance. **Over torquing the u-bolt may result in damage to the pipe and/or casting which could result in pipe joint separation.** Under torquing the u-bolt may result in lower pressure retention capabilities, lower bend load capabilities, joint leakage and pipe joint separation. Pipe joint separation may result in significant property damage and serious injury.



National Fire  
Equipment Ltd.

TORONTO: (905) 761-6355  
Toll Free: (800) 267-8508  
OTTAWA: (613) 723-6071

VANCOUVER: (604) 420-1131  
Toll Free: (800)-667-2138  
BURNABY: (604)-299-4498

EDMONTON: (780) 455-3870  
Toll Free: (888)-891-1008  
CALGARY: (403) 236-5661

MONCTON: (506) 859-7277  
Toll Free: (877) 816-3473  
MISSISSAUGA: (905) 565-1385

[www.nationalfire.com](http://www.nationalfire.com)